

# PRO-Grip™ 90° Head Instructions

Turn any of your PRO-GRIP™ straight edge clamps in to a large t-square. The large 90 degree head slides directly over the top of the PRO-GRIP™ clamp head, and it fastens securely on to the clamp with two screws (included). Attaching the 90° head allows you to line up your clamp square to the edge of your stock for fast and easy 90 degree cuts.

## Step 1

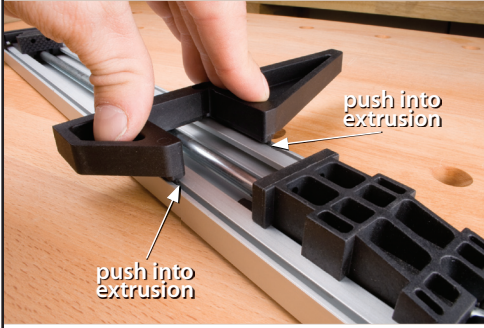

Push the grooved ends of the 90° Head into the under side extrusions of the PRO-Grip™ Clamp. The 90° Head should fit snug in the extrusion.

## Step 2

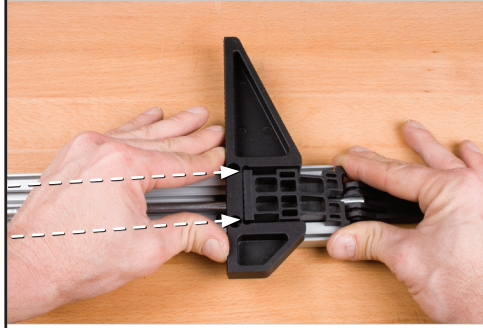

Slide the 90° Head firmly up against the fixed jaw pad, making sure the 90° Head does not have any side to side movement.

## Step 3



Select a piece of stock that you know is square. Place the selected stock in between the clamp jaws with the 90° head in place. Slide the adjustable clamp head against the side of the stock. Check to make sure the stock is at 90° with a square. (Do not lock clamp until you are finished squaring the 90° Head)

## Step 4



Once the clamp is at 90° to the board, lock the clamp to the stock piece with the cam lock lever.

## Step 5



With the clamp and the stock locked into position, secure the 90° Head to the clamp with the two self-tapping screws provided.



Your PRO-Grip™ Clamp and 90° Head are now ready to be used as a large square for virtually any large piece of stock in your shop.