

Rail Guide Coping Sled PRO

Clean, Square Cuts Everytime

Version 1.0

Safety First



Disconnect saw from power source before fitting or removing insert.



Always wear proper ear protection when working with machinery.



Use caution when handling sharp objects (saw blades, router bits, drill bits and so on). Use protective gloves whenever possible.



Always wear proper eye protection when working with machinery and tools.



Always wear proper respiratory protection when working near airborne dust particles.

Please read and fully understand any and all safety materials that came with your power tools or machinery before operation. Always follow all safety guidelines set in place by the power tool or machine manufacturer.

Exploded View & Parts List

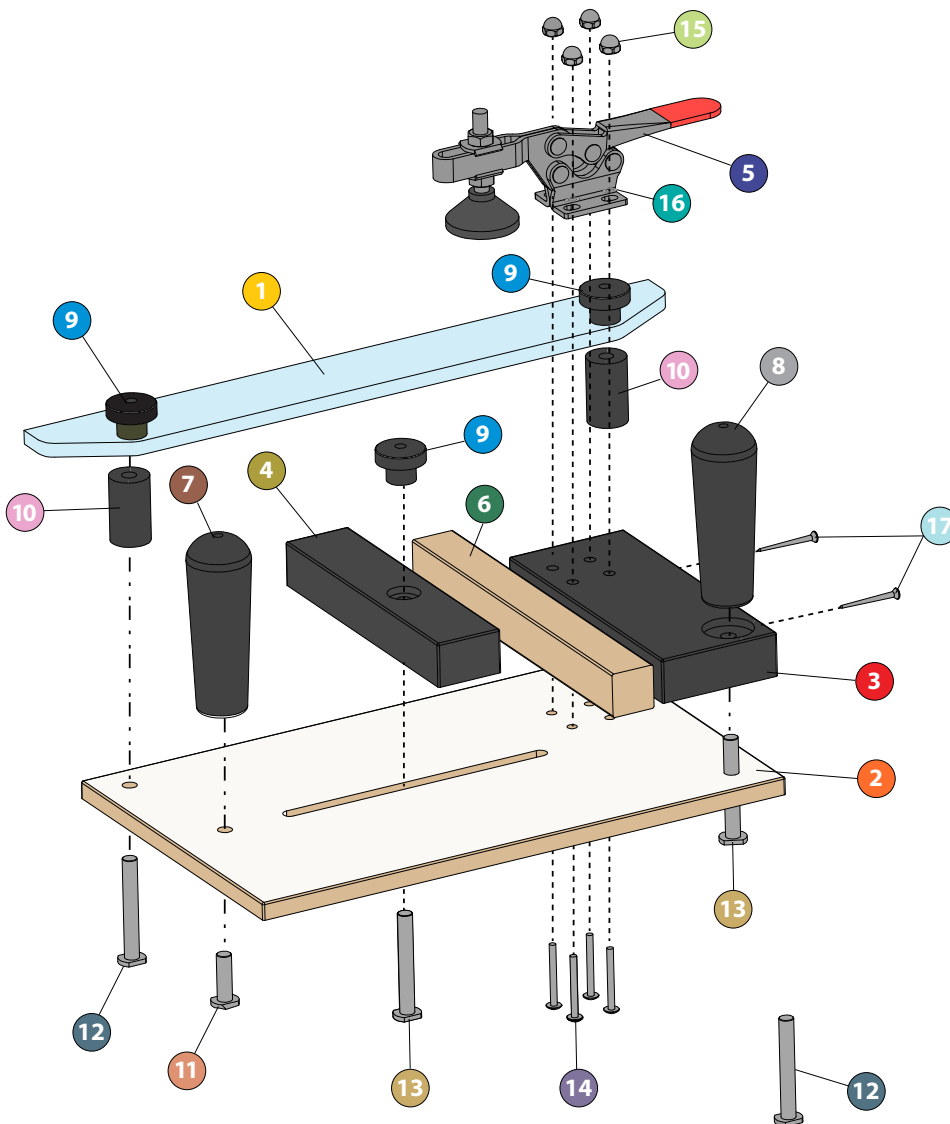

PARTS LIST - Coping Sled Pro

No.	Description	Quantity
1	Clear Acrylic Fence Guide	1
2	Coping Sled Base	1
3	Fixed Fence	1
4	Adjustable Fence	1
5	Toggle Clamp	1
6	Sacrificial Wood Backer Block	1
7	Post Handle Front	1
8	Post Handle Back	1
9	1" Threaded Round Knob	3
10	Black Bushing	2
11	1" x 5/16 tpi T-bolt	1
12	2 1/2" x 5/16 tpi T-bolt	2
13	1 3/4" x 5/16 tpi T-bolt	2
14	1 3/4" x 24 tpi bolt	4
15	Capped Nut	4
16	Steel Washer	4
17	1 3/4" Wood Screws	2

Basic Assembly

- Assemble the Rail Coping Sled Pro as shown in the exploded drawing. Do not attach the Sacrificial Wood Backer Block at this time. This will be done once the calibration process is complete. Once the sled is assembled, loosen the 1" round knobs on top of the Clear Rail Guide as well as the rear Post Knob Handle and the four cap nuts on the toggle.

Setup and Use

Calibrating The Sled

1. With the 1" round knobs loosened, place the Rail Coping Sled Pro onto your router table with the Clear Acrylic Fence Guide snugly up against the router table fence.
2. Adjust the coping sled so that Coping Sled Base is exactly 3/4" away from the router table fence. This measurement needs to be accurate, so be sure to measure at both ends of the Coping Sled Base. Once you have both ends of the base set at 3/4" away from the router table fence, make sure the Clear Acrylic Fence Guide is against the router table fence, firmly secure the 1" round knobs.



3. With the 4 cap nuts on the toggle and the rear post knob loose, keep the Clear Acrylic Fence Guide against the router fence, use a square to set the Fixed Fence to 90° in reference to the Coping Sled Base. Once you have the Fixed Fence set, firmly secure the rear Post Knob Handle.

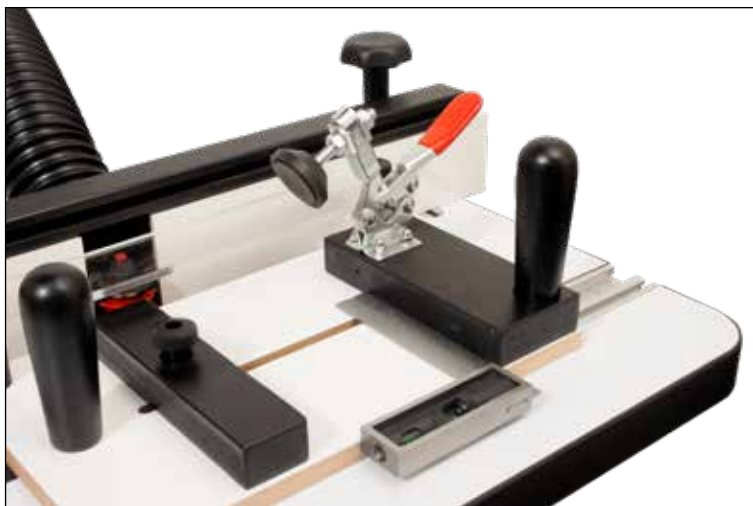

4. Lay the Rail Coping Sled Pro on its side and secure the Toggle to the Fixed Fence using the wrench provided and a philips head screw driver (not included).
5. Double check that the Fixed Fence is still square to Coping Sled Base.



Setting the Router Bit Height

6. Set a test piece of stock (must be same thickness as your actual stock piece) on to the Sled Base (2). Following the router bit manufacturers instructions, set the bit height.
7. Once you have the bit height set, secure the router bit to lock it into position.
8. Adjust your router table fence so that the fence is flush with the router bit's bearing and secure the fence in place. Following the router bit manufacturers instructions, set the bit fence.

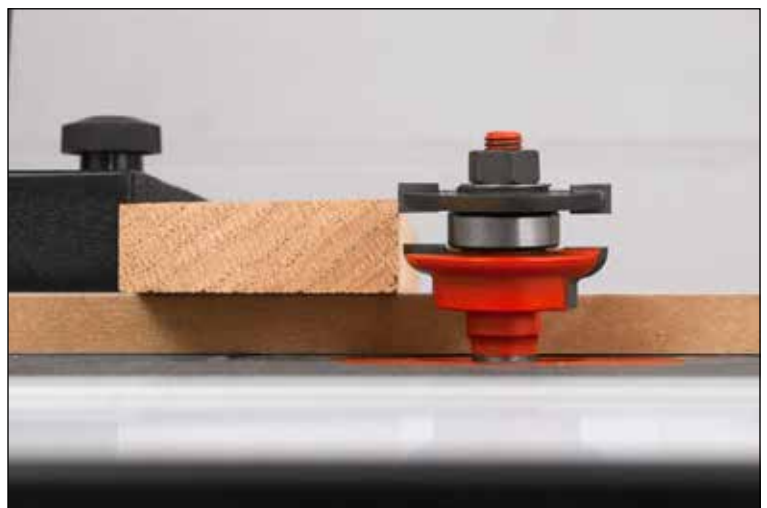

9. Once the router bit height is set, place the Coping Sled on to the router table with the Clear Acrylic Guide flat against the router fence.

10. Place a test stock piece against the fixed fence and slide the end to be cut against the router table fence.
11. Move the adjustable fence so that it fits flat against the other side of the stock and secure the 1" knob on the adjustable fence.
12. Adjust the toggle foot assembly so that it firmly holds your stock in place. Once the toggle is adjusted, engage the toggle so that it is holding the stock down.



13. Make a test cut.



14. If necessary, repeat the router bit height setup process until the stile and rail mate perfectly as shown below.

Please note that your Rail piece(s) should already be cut.



15. Once you are satisfied with your fit, attach the Sacrificial Wood Backer Block as detailed in the following steps.
16. Place the Coping Sled back on to the router table with the Clear Acrylic Fence Guide against the router table fence. Set the Sacrificial Wood Backer Block against the Fixed Fence. Slide the end against the router table fence and secure the Sacrificial Wood Backer Block using the two supplied wood screws that came with the coping sled.

Please note: When securing the Sacrificial Wood Backer Block against the Fixed fence, make sure it aligns with the Clear Acrylic Fence.



17. Use a combination or engineer's square to verify that the Sacrificial Wood Backer Block remained square to the router table fence.
18. Your Rail Guide Coping Sled Pro is now setup for your first cope cut. Secure your project project piece into the sled and make your cuts!



Shop Tip

To accommodate different router bit profiles, you will need to make your own replacement Sacrificial Wood Backer Block. Do not throw away the old block, this can be used again for future projects.