

DELUXE DRILL PRESS TABLE

With L Fence and Hold downs

Version 1.0

Safety First



Disconnect saw from power source before fitting or removing insert.



Always wear proper ear protection when working with machinery.



Use caution when handling sharp objects (saw blades, router bits, drill bits and so on). Use protective gloves whenever possible.



Always wear proper eye protection when working with machinery and tools.



Always wear proper respiratory protection when working near airborne dust particles.

Please read and fully understand any and all safety materials that came with your power tools or machinery before operation. Always follow all safety guidelines set in place by the power tool or machine manufacturer.

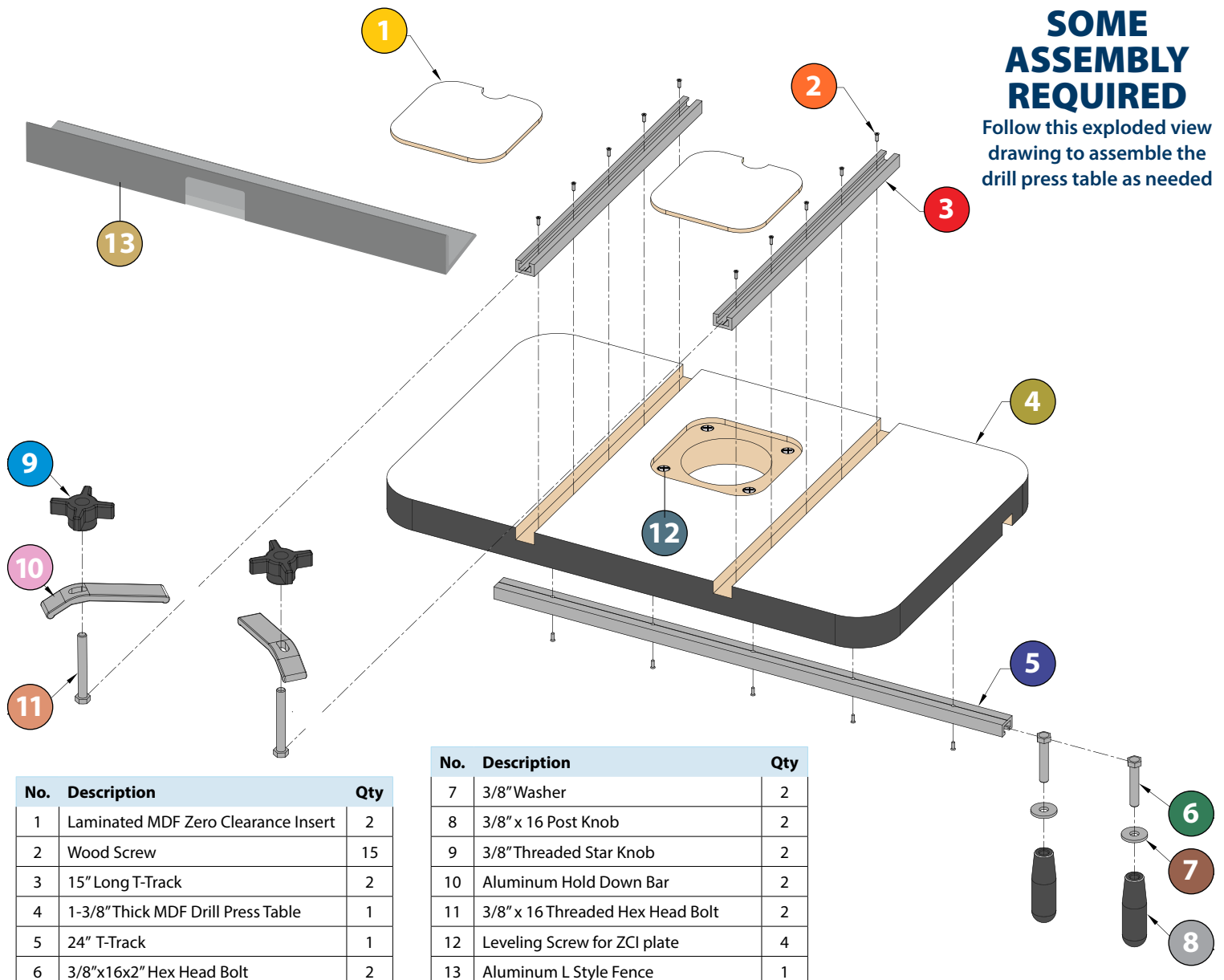

SOME ASSEMBLY REQUIRED

Follow this exploded view drawing to assemble the drill press table as needed

No.	Description	Qty
1	Laminated MDF Zero Clearance Insert	2
2	Wood Screw	15
3	15" Long T-Track	2
4	1-3/8" Thick MDF Drill Press Table	1
5	24" T-Track	1
6	3/8"x16x2" Hex Head Bolt	2

No.	Description	Qty
7	3/8" Washer	2
8	3/8" x 16 Post Knob	2
9	3/8" Threaded Star Knob	2
10	Aluminum Hold Down Bar	2
11	3/8" x 16 Threaded Hex Head Bolt	2
12	Leveling Screw for ZCI plate	4
13	Aluminum L Style Fence	1

HOW TO MOUNT YOUR TABLE TOP

Before mounting the drill press table, you must determine the best mounting method. Your mounting method is determined by the type of cast iron table that is on your drill press. There are two basic types of cast iron table tops and two basic mounting methods.

ALUMINUM MOUNTING TRACK

WILL BE USED FOR BOTH MOUNTING METHODS

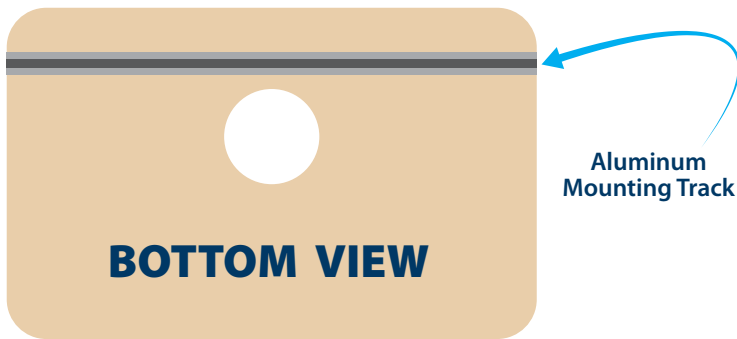

The Aluminum Mounting Track that is secured to the bottom of the drill press table makes mounting the Deluxe Drill Press Table quick and easy.

THROUGH SLOT

FACTORY TABLE TOP

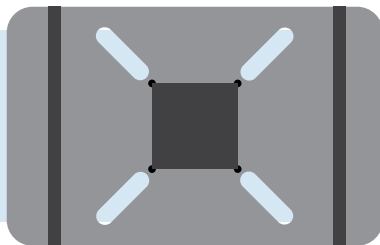

The through slot table top is the most common factory table top and allows the Fulton Deluxe Table top to be mounted using the included post knob and bolt hardware.

Slide the two 3/8"x16x2" (11) Hex Head Bolts into the 24" long track (5) that is mounted to the bottom of the table. Position the bolts so they line up with two of the through slots on the factory table top. Place the Fulton Drill press table on to the factory table top so the bolts drop through the slots. Secure the table top using the post knobs and washers as shown here.

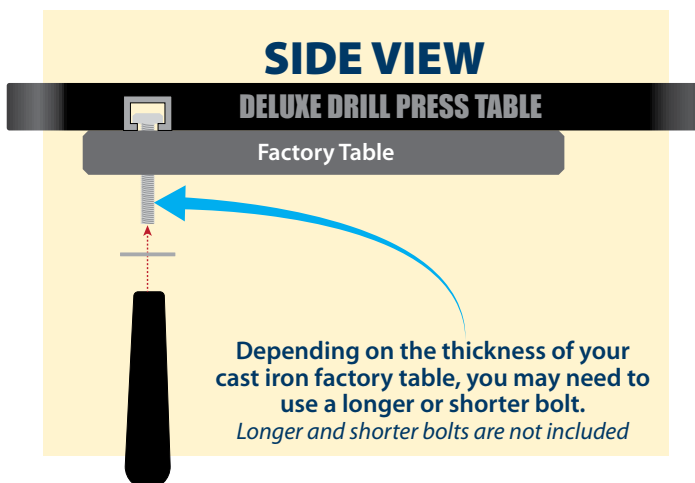

SOLID SURFACE / INTERNAL SLOT

FACTORY TABLE TOP

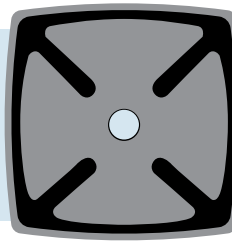

Typically found on smaller or bench top drill press machines, the internal slot table tops require the use of Hold Down Clamps to mount the Fulton Deluxe Table Top.

Place the Fulton Deluxe Drill Press Table on to your factory drill press table and the two tables. Slide one aluminum 3/8" hex head bolt hold downs (11) into one side of the 24" track (5) and the another into the opposite side. Secure the Fulton Deluxe Drill Press Table to the factory table by clamping the two sides as shown below. The clamps may be used in either direction depending on the size and thickness of the factory table top.

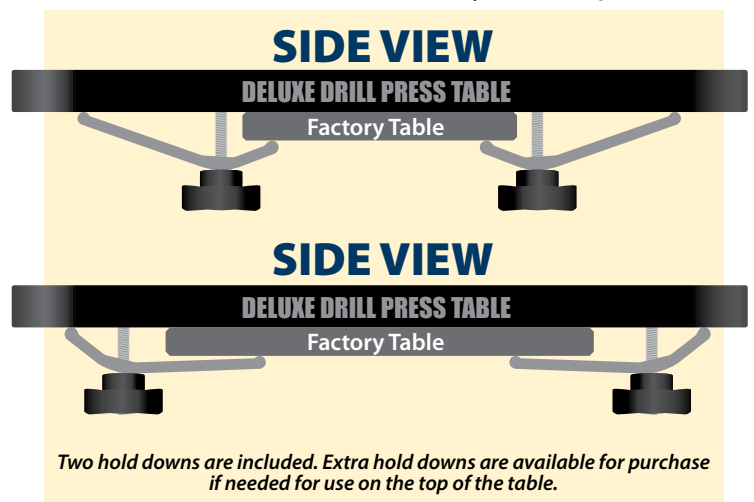

CONVERT YOUR DRILL PRESS INTO A DRUM SANDER



Simply drill a hole in the zero clearance insert that is slightly larger than your sanding drum diameter to create the perfect size opening for sanding your project. The 3-5/8" opening underneath the insert allows you to drop the drum sander below the surface of the table top to ensure complete sanding surface coverage and optimal sanding results. Using drum sanders on your drill press with this table is almost like using one of those expensive drum sanding machines without spending the big money for one.