

Safety First



Disconnect saw from power source before fitting or removing insert.



Always wear proper ear protection when working with machinery.



Use caution when handling sharp objects (saw blades, router bits, drill bits and so on). Use protective gloves whenever possible.



Always wear proper eye protection when working with machinery and tools.



Always wear proper respiratory protection when working near airborne dust particles.

Please read and fully understand any and all safety materials that came with your power tools or machinery before operation. Always follow all safety guidelines set in place by the power tool or machine manufacturer.

PLEASE NOTE:

Depending on the type of insert, certain steps in these instructions may not apply. Example: Some inserts do not have leveling or adjustment screws.

1. Square up your saw blade

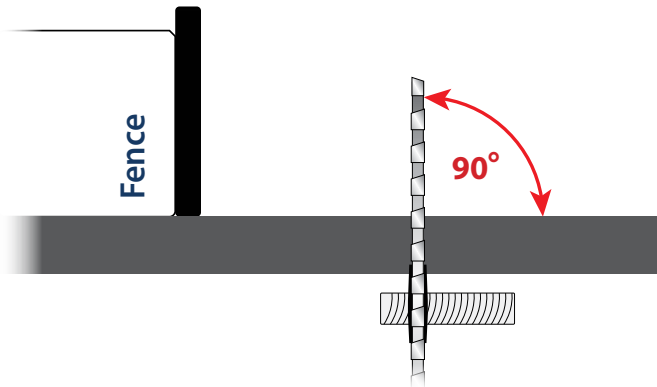

It is important to make sure that your table saw blade is square to your table top. If the blade is not square prior to the zero clearance installation process, the slot will be off and cannot be corrected once the slot cut is made.

2. Insert Placement & Proper Fitting

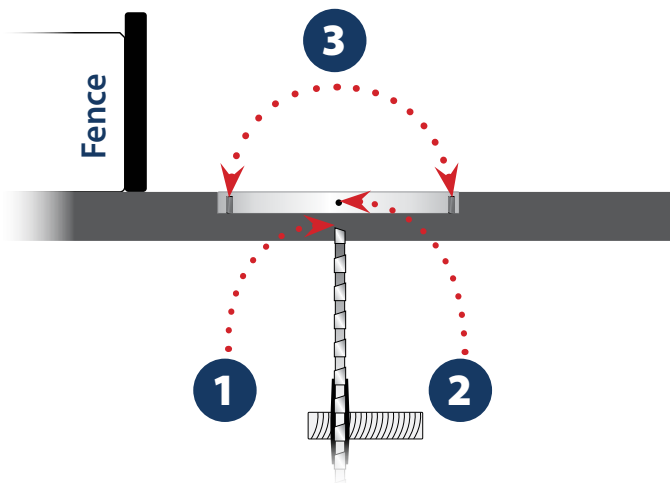

1. Lower the table saw blade completely. Place the insert into the table with pin or clip (when applicable) pointing toward to the back end of the table saw.

Shop Note: If the insert doesn't sit flush because of the blade, remove the blade and replace it with a smaller diameter blade.

2. When placing the zero clearance insert into the saw, the finger hole (when insert is equipped with a finger hole) must be facing the front side of the saw.

3. Adjust leveling screws (when insert is equipped with leveling screws) down until the insert is stable and flush with the tabletop.

4. If your original table saw insert was equipped with hold down screws, use those screws to secure your new zero clearance into the table saw.

Shop Tip: Cut out the Splitter/Riving Knife Slot

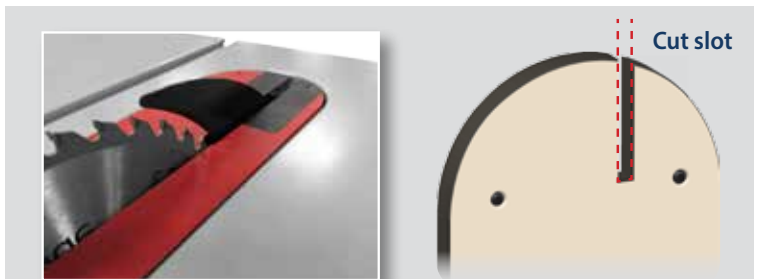

If your saw has a built in splitter or riving knife you need to cut a slot at the rear of the insert. Trace the outline of the slot from your original metal insert, and cut the slot with a bandsaw or a jigsaw. Leave the bridge between the splitter slot & the blade slot as thick as possible.

3. Adjust Front Screw

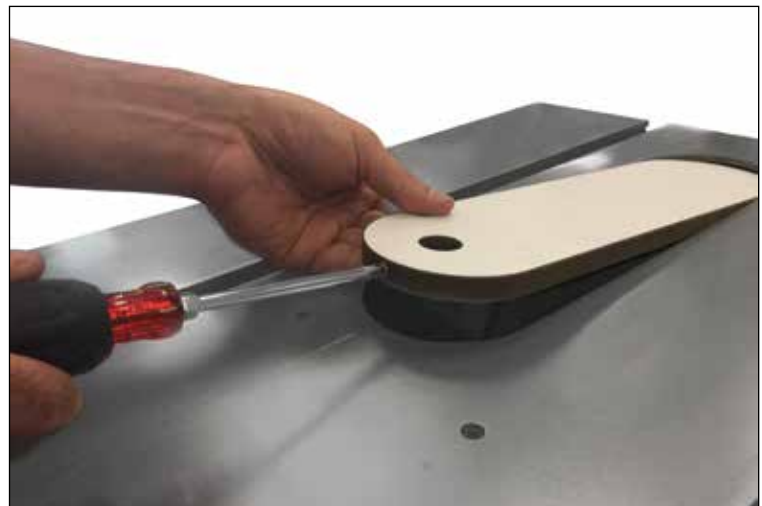

Depending on your saw, your new insert plate may not initially seat snugly into the saw. To address this, some phenolic inserts are equipped with a side screw and a front screw to micro-adjust the fit.

1. To eliminate any front to back movement of the insert, you must adjust the front side screw.

2. Raise the front end of the insert out and either tighten or loosen the screw until the insert sits firmly (with slight resistance) into the saw.

3. Once you have eliminated any movement from the insert push the insert firmly into the saw so that it fits snugly in place.

4. Adjust Side Screw



1. To eliminate any side to side movement of the insert, you must adjust the side screw.
2. Raise the side of the insert out and either tighten or loosen the screw until the insert sits firmly (with slight resistance) into the saw.



3. Once you have eliminated any movement from the insert push the insert firmly into the saw so that it fits snugly in place.

Your insert should now be set. It should be flush with the table top and it should have no movement side to side or front to back

CAUTION:
WHEN CUTTING THE INSERT MAKE SURE THE SIDE ADJUST SCREW DOES NOT COME INTO CONTACT WITH YOUR SAW BLADE.

OOPS! I bought the wrong size insert...

Please Include the following information with the return:

1. A paper tracing / outline of your factory zero clearance for correct matching purposes
2. Your telephone number
3. \$6.75 for shipping and handling

If you accidentally purchased the wrong zero clearance insert, Please return to Fulton Woodworking Tools and Accessories at the following address:

Returns
6684 Jimmy Carter Blvd Suite 100
Norcross GA 30071

5. Cutting the saw blade kerf slot

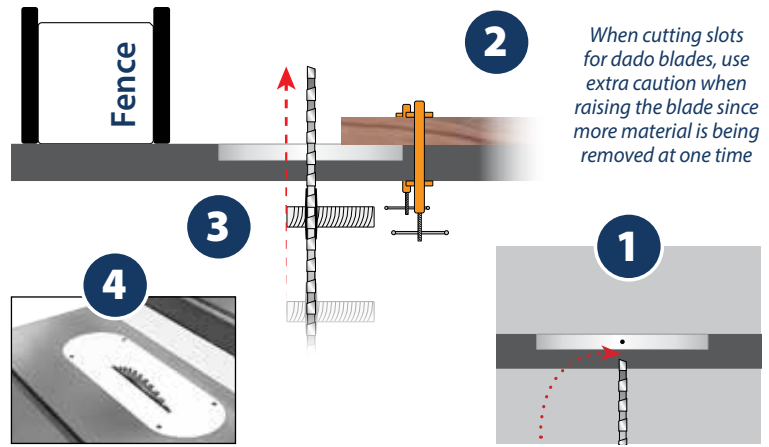

1. Check that the insert is fitted properly, and that the blade is clear of obstruction.
2. Partially cover the insert with a board as long as the tabletop, and clamp at each end to the table saw top. Make sure the board will NOT contact the blade as it passes through the insert.
3. Re-connect the power to the saw. Switch on, slowly raise the blade up to cut its way through the insert. Raise the saw blade to maximum cutting height.
DO NOT STAND DIRECTLY BEHIND THE INSERT WHILE RAISING THE BLADE. KEEP HANDS OFF THE INSERT AND WOOD WHILE RAISING THE BLADE
Shop Note: If you are using a smaller diameter blade, you must score the bottom of the insert enough to fit the full diameter size blade. Once scored, power down, unplug and swap out blades and follow the previous step 3 "Cutting the saw blade kerf slot" from the beginning.
4. Lower the blade, turn off saw and wait for blade to come to a complete stop, remove the board and your tablesaw zero clearance is ready for use!

Zero Clearance Tips

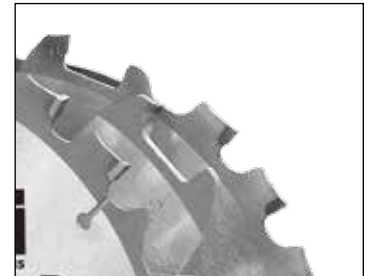
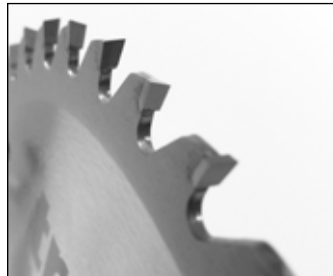

1. These Phenolic inserts are recommended to be used with carbide tipped blades only.
2. Dado blade inserts use same procedures outlined in these instructions, but use additional caution due to excessive material being removed from insert during the slot cutting procedures.
3. Under certain conditions your saw blade may generate an undesirable scraping noise. Planer type blades and or excessive arbor run-out and or blade distortion may be causing intermittent contact with the insert slot. To fix this, remove the insert and slightly widen the slot using a file or sanding paddle.
4. Ideally, a separate insert should be used when ever a blade is changed on your saw or change of angle is made. This will insure a true "Zero Clearance" effect and give you the maximum benefit of your inserts.



Phenolic Zero Clearance Insert